

**TECHNICAL NOTES
NOTES TECHNIQUES
TECHNISCHE
DATEN**

**Concentricity of collets
Concentricité des pinces de serrage
Spannzangen-Rundlauf**

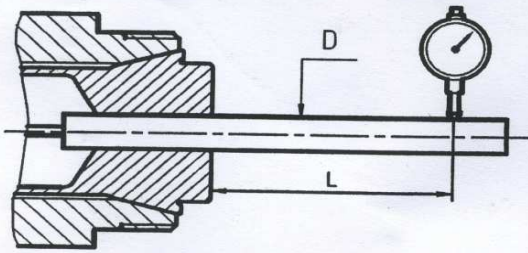

D	L	DIN 6343	Standard				U.P.		
		○	○	⬡	□	○	⬡	□	
0,5	3	0,015	0,01						
0,5 - 1	3	0,015	0,01			0,005			
1 - 1,6	6	0,02	0,01	0,05	0,05	0,005	0,03	0,03	
1,6 - 3	10	0,02	0,015	0,06	0,06	0,008	0,04	0,04	
3 - 6	16	0,02	0,015	0,06	0,06	0,008	0,04	0,04	
6 - 10	25	0,02	0,015	0,06	0,06	0,008	0,04	0,04	
10 - 18	40	0,03	0,02	0,06	0,06	0,01	0,04	0,04	
18 - 24	50	0,03	0,02	0,06	0,06	0,01	0,04	0,04	
24 - 30	60	0,03	0,02	0,06	0,06	0,01	0,04	0,04	
30 -	60	0,04	0,03	0,06	0,06	0,015	0,04	0,04	

**Execution of grooves inside collets
Exécution des alésages sur les pinces de serrage
Ausführung von Bohrungen**

**Positional slot
Rainure de clavette
Verdrehsicherungsnut**

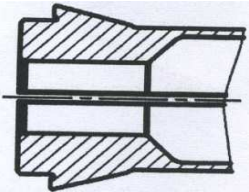

smooth
lisse
glatt

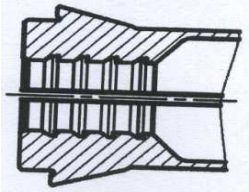

grooved
rainuré
Querrillen

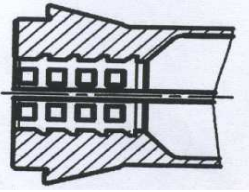

serrated
quadrillé
Querrillen und Längsrillen

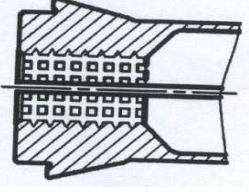

diamond tops
pointes diamant
geriffelt

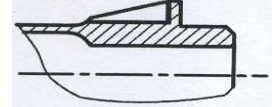
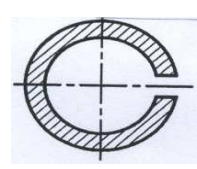
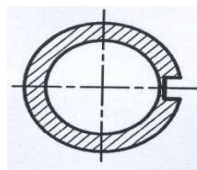
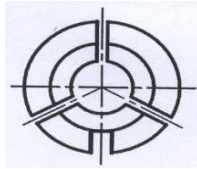
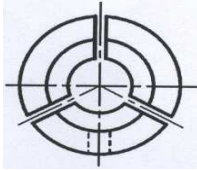

rainure sur cône

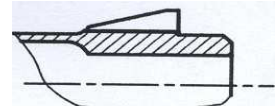

rainure sur cône débouchante

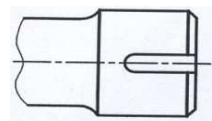

rainure de clavette

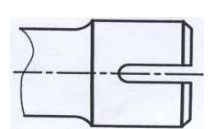

rainure de clavette débouchante

Types A, B, D, E, L, P, W - usually **SMOOTH**
Types A, B, D, E, L, P, W - généralement un alésage **LISSE**
Type A, B, D, E, L, P, W - allgemein **GLATT**

Types F - from ○ > 8 mm and ⬡□ > 14 mm = **GROOVES**
Types F - à partir de ○ > 8 mm et ⬡□ > 14 mm = **RAINURES**
Typ F - ab ○ > 8 mm und ⬡□ > 14 mm = **QUERRILLEN**